



MEGAHERTZ TIMES



April 2023

W3AI

PO Box 336, Perkasio, PA 18944

R F Hill Amateur Radio Club 2023

President: John Morell KB3EWW

Vice Pres.: Cary Binder NI2Q

Secretary: John Stewart WA3JRS

Treasurer: Charles Schmell KS3Z

News Editor: W3WTT, Bill Tribley

bill@tribley.org

CLUB INFORMATION

Mailing address:

PO Box 336, Perkasio, PA 18944

Club Repeaters: 145.31 MHz; input

144.71 MHz PL 131.8 (2 meters)

444.75 MHz; input 449.75 MHz PL 103.5
(70 cm)

Meetings: The club normally meets at
7:30 PM on the last Thursday of the
Month

Web page: <http://www.rfhillarc.club>

Email: rfhillarc@yahoo.com

The MHz Times is the official publication of the R F Hill Amateur Radio Club, Inc. Articles for submission may be made to the editor. Material may not be reprinted without the express permission of the R F Hill ARC. The R F Hill ARC nor its officers warrant any items listed for sale or trade. The editor reserves the right not to print any material which may be offensive or illegal.

All articles and pictures are copyrighted material. ©2022

DEADLINE for article submission is 6 days before the meeting! Please submit in Open Office (.odt) or MS Word (.docx) format. No PDFs please!

Send to bill@tribley.org

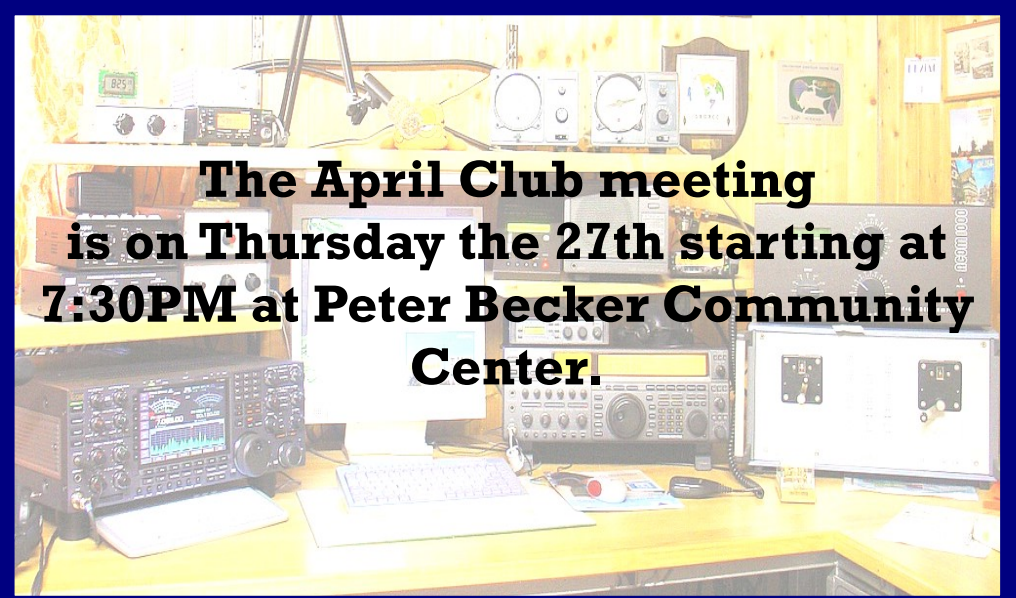

RF Hill Amateur Radio Club
W3AI

VE TESTING

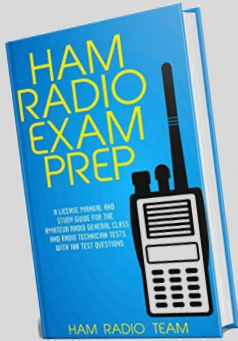

VE testing for Technician, General and Extra Class licenses is held at 6:00PM at the Indian Valley Public Library in Telford:

100 E Church Ave.
Telford, PA 18969



Scheduled VE Exam Sessions

- *May 15*
- *July 17*
- *Sept. 18*
- *Nov. 20*

Direct questions to Kevin KW3P at kw3p@arrl.net or by cell phone at 215-378-6978.



Highlighted Nets

SEPPTN traffic nets are on Sundays & Wednesdays at 8:00 PM local time at 145.310 MHz (-600). These nets are for anyone who would like to learn how to handle traffic as well as an on the air meeting place for members and future members.

RF Hill A-R-C Ten Meter AM Net: 29.005MHz on Sunday evening immediately following the SEPPTN

RF Hill CW Squad Net: Operates on 28.370.600 CW at approx. 7pm Tuesday stopping before the NPARC net at 8pm. This is a non formal CWs - slow speed - net for beginners and ranges in speed from 5-15 wpm.

Net Control Stations

04/23, 04/26 WA3YLQ 07/05 W3WTT
 04/30 NE3I
 05/03 W3WTT
 05/07 NE3I
 05/10 W3WTT
 05/14, 05/17 KB3DEN
 05/21, 05/24 WA3YLQ
 05/28 NE3I
 05/31 W3WTT
 06/04 NE3I
 06/07 W3WTT
 06/11, 06/14 KB3DEN
 06/18, 06/21 WA3YLQ
 09/25 NE3I
 06/28 W3WTT
 07/02 NE3I

Contact Jim KB3DEN with any questions or conflicts. If at the last minute, the assigned net control station doesn't show-up, any net control station on frequency should run the net.

Thanks to everyone for your continued support.
 Jim – KB3DEN KB3DEN@aol.com

AREA NET LISTINGS

| | | | |
|--|-------|---------|--------------------|
| SEPPTN Southeastern PA Practice & Traffic Net | Su/W | 8 PM | 145.31- |
| EPAEPTN - EPA Emergency Phone/Traffic Net | Daily | 5 PM | 3.918 +/- |
| Pennsylvania Traffic Net (CW) | Daily | 7,10 PM | 3.585 |
| Third Region Net | Daily | 4 PM | 7.243 (3.917 -alt) |
| Eastern Area Net (EAN) | Daily | 2:30 PM | 7.243 |
| Bucks County ARES | W | 9 PM | 147.090+ |
| Montgomery County ARES | Th | 7 PM | 146.835- (pl 88.5) |
| EPA echo link traffic net (EAETN) Echolink AA3RG-R | Th | 8 PM | 146.640- (pl 82.5) |



Find us on Facebook and Twitter

Join the conversation.

Follow us today!

<http://facebook.com/rfhillarc>

<http://twitter.com/W3AI>



RF Hill SEPPATN March Report

QNI = 105

QTC = 6

In 9 Sessions

That's over 11 Check-in's per session!

73's, Jim KB3DEN

Antenna Day Saturday, May 6

As with antenna days in the past there is little to no plan! Bring out your projects your rigs and anything else you wish to experiment with. Members can share knowledge and ideas.

Location: Markey Park aka The Field Day Site

Schedule:

10:00AM Meet and greet.

10:00—11:00 Set up masts and gear.

11:00—12:00 Test and adjust. No transmitting.

12:00—Whenever End test and adjust. Radio Transmissions permitted at the Range Officers' discretion.

Additional Points:

- Club trailer will be on-site to work from and all club materials will be available including tables, masts, miscellaneous, coax, and electric if needed! To ensure everyone has the best time possible an operating schedule has been planned.
- We all know the difficulties of trying to test an antenna with a operating station 10-30 feet away!
- A Range Officer will coordinate operations and to prevent any two stations from unintentional interference.

Any questions, comments or opinions please feel free to let me know

Thanks

John KB3EWV

FEDS April 2 At Franconia Community Park



Gene and Griff working 10 Meter AM with a Radio Shack HTX 10 and 40 Meter EFHW



Gene's CW Mobile



Kevin KW3P and Jim WA3YLQ visiting with Dan WA3NFV



Ned WQ3Z happily working stations with a new 10 Meter Vertical and psychedelic sun glasses



WA3NFV's Solar Powered TV Tray 10 Meter AM Rig that worked Texas

Thanks to Griff NE3I for these photos and captions!

Fun Facts from Lamar K3UCI

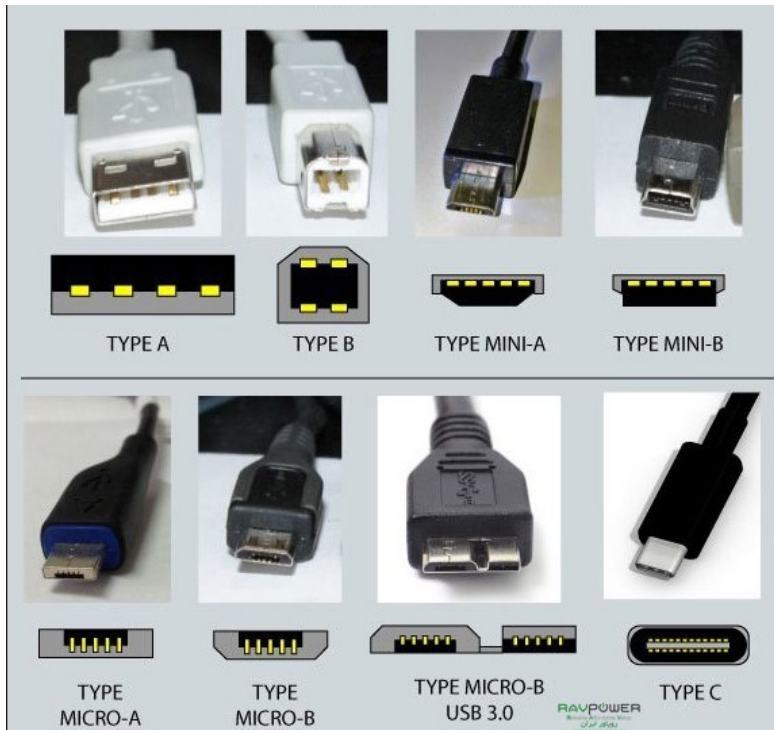

AUTISM TEST

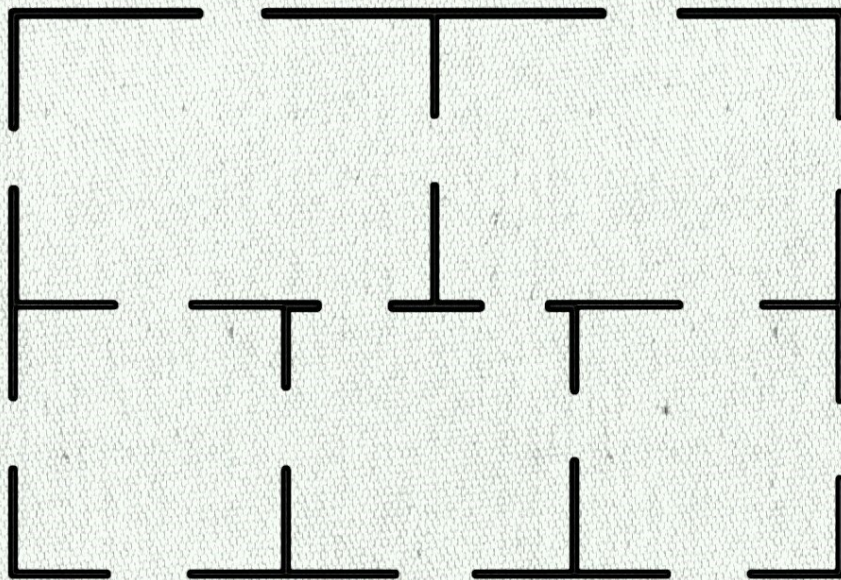

Begin wherever you want and draw one line through all of the doors, but you cannot go through same door twice. Hard, but possible!

Cary NI2Q Hex Beam Antenna



Installing the support pipe.



Center post mounted on the spreader plate with 6 the 6 largest spreader elements attached.



Attach coax with common mode choke inside a PVC tube.

Cary NI2Q Hex Beam Antenna p.2



Hex Beam without rotator, at 25 feet to the very top.